



IMMOTROPICAL

REAL ESTATE COSTA TROPICAL

— www.immotropical.com —

San Pedro de Alcántara, Costa del Sol, Espagne

ID#: 207553



CUADRO DE SUPERFICIES

PLANTAS	SUPERFICIE UTIL	SUPERFICIE CONSTRUIDA	TERRAZAS CUBIERTAS	PATIOS Y TERRAZAS DESCUBIERTAS
PLANTA SÓTANO	179,45 m ²	114,70 m ²	---	---
PLANTA BAJA	35,60 m ²	46,30 m ²	51,40 m ²	14,95 m ²
PLANTA PRIMERA	57,75 m ²	73,85 m ²	10,20 m ²	6,00 m ²
TOTAL	272,80 m ²	234,85 m ²	61,60 m ²	20,95 m ²
TOTAL SOBRE BASANTE	93,35 m ²	120,15 m ²	61,60 m ²	20,95 m ²
SUP. COMPUTABLE	---	120,15 m ²	---	---
TOTAL COMPUTABLE		120,15 m ²		

PISCINA 4,60 m²

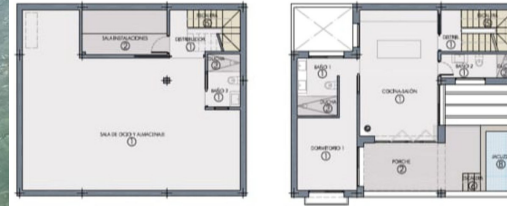

Description:

OPPORTUNITY, Plot in an exceptional situation. The plot is qualified as buildable, the construction of the following is allowed: Single-family housing Multi-family housing
Compatible uses: Commercial premises It has a building license for the construction of a single-family house and a commercial premises, the architecture project and the license are also delivered. The project can be modified or completely changed. The location is unbeatable ...

• **Chambres:** 0 | • **Salles de bain:** 0 | • **Terrain:** 245 m² |

Général: Proche des commerces, Etat excellent, Urbanisation

€440,000